



(LTR)

Report No. LO-87-80-134

Date: May 28, 1980

RELEASED BY LOFT CDCS *sh*

RE&C Internal Report RE-A-80-047

~~USNR 1354~~

INTERNAL TECHNICAL REPORT

Title: STRESS ANALYSIS OF THE
MODIFIED PULSED NEUTRON ACTIVATION
SYSTEM DOWNSTREAM SHIELD
SUPPORT STRUCTURE

Organization: Applied Mechanics Branch

Author: W. R. Mosby/ *W.R. Mosby*

Checked By: D. P. Finicle/ *D.P. Finicle*

Approved By: R. C. Guenzler/ *R.C. Guenzler*

- cc: J. R. Barker (3)
- D. P. Finicle
- V. W. Gorman *OUT*
- R. C. Guenzler
- M. M. Laughlin (3)
- W. R. Mosby

Courtesy release to the public on request.
This document was prepared primarily for
internal use. Citation or quotation of this
document or its contents is inappropriate.



DISTRIBUTION OF THIS DOCUMENT IS UNLIMITED

DISCLAIMER

This report was prepared as an account of work sponsored by an agency of the United States Government. Neither the United States Government nor any agency thereof, nor any of their employees, makes any warranty, express or implied, or assumes any legal liability or responsibility for the accuracy, completeness, or usefulness of any information, apparatus, product, or process disclosed, or represents that its use would not infringe privately owned rights. Reference herein to any specific commercial product, process, or service by trade name, trademark, manufacturer, or otherwise does not necessarily constitute or imply its endorsement, recommendation, or favoring by the United States Government or any agency thereof. The views and opinions of authors expressed herein do not necessarily state or reflect those of the United States Government or any agency thereof.

DISCLAIMER

Portions of this document may be illegible in electronic image products. Images are produced from the best available original document.

INTEROFFICE CORRESPONDENCE

R-5652

date **JUN 04 1980**
 to DISTRIBUTION
 from LOFT CDCS, TAN 602, Ext. 6177 *S K Hathaway*
 subject DOCUMENT TRANSMITTAL

MASTER

The following documents released by LOFT CDCS, are hereby transmitted for your use and information:

DOCUMENT NO.	REV	CHG	DATE
LTR LO-87-80-134	Ø		5-28-80
"Stress Analysis of the Modified Pulsed Neutron Activation System Downstream Shield Support Structure" W. R. Mosby			

REMARKS: Reference No. 6, LTR LO-87-79-127, will be issued at a later date. No other disposition is required.

Distribution

W. Amidei w/o Att.	D. B. Jarrell	W. A. Spencer
B. O. Anderson	N. C. Kaufman w/o Att.	J. C. Stachew w/o Att.
E. C. Anderson w/o Att.	S. T. Kelppe	T. Sudoh - 1
B. L. Chamberlain	J. H. Linebarger	K. C. Sumpter
T. C. deBoer	J. L. Liebenthal	R. E. Tiller
G. A. Dinneen	A.S. Lockhart	S. R. Wagoner w/o Att.
D. B. Engelman	D. W. Marshall w/o Att.	G. Weimann
B. L. Freed-Orig.+7	S. Matovich	D. J. Hansen
R. T. French	G. D. McPherson	R. E. Ford <i>RE3/ah part telecon</i>
R. C. Gottula	S. A. Naff	W. R. Mosby <i>6-2-80</i>
V. W. Gorman	N. E. Pace w/o Att.	J. R. Barker - 3
R. C. Guenzler	T. F. Pointer	D. P. Finicle
J. C. Haire	G. Rieger	M. M. McLaughlin - 3
J. L. Hansen	P. Schally	L. S. Haas
G. L. Hunt w/o Att.	D. G. Satterwhite w/o Att.	
F. K. Hyer w/o Att.	K. Soda - 2	

LOFT TECHNICAL REPORT

Title		LTR No.
STRESS ANALYSIS OF THE MODIFIED PULSED NEUTRON ACTIVATION		LO-87-80-134
SYSTEM DOWNSTREAM SHIELD SUPPORT STRUCTURE		RE-A-80-047
Author	Released By LOFT CDGS	
W. R. Mosby	Date May 28, 1980 <i>sh</i>	
Performing Organization	Project System Engineer	
Applied Mechanics Branch <i>R. C. Grewler 4/24/80</i>	<i>R. T. Ford 4/30/80</i>	
LOFT Review and Approval		
<i>[Signature]</i> <i>[Signature]</i> 4-30-80		

PSB Mgr.

LMD Mgr.

DISCLAIMER

This book was prepared as an account of work sponsored by an agency of the United States Government. Neither the United States Government nor any agency thereof, nor any of their employees, makes any warranty, express or implied, or assumes any legal liability or responsibility for the accuracy, completeness, or usefulness of any information, apparatus, product, or process disclosed, or represents that its use would not infringe privately owned rights. Reference herein to any specific commercial product, process, or service by trade name, trademark, manufacturer, or otherwise, does not necessarily constitute or imply its endorsement, recommendation, or favoring by the United States Government or any agency thereof. The views and opinions of authors expressed herein do not necessarily state or reflect those of the United States Government or any agency thereof.

ABSTRACT

The modified LOFT Pulsed Neutron Activation (PNA) System downstream shielding support structure was stress analyzed for deadweight and worst-case LOCE loads. No deficiencies were found in the structure. This stress analysis was performed for the PNA Shielding Configuration that has been used on Test L3-2 and that is to be used on Test L3-7.

DISPOSITION OF RECOMMENDATIONS

Reference No. 6, LTR LO-87-79-127, will be issued at a later date. No other disposition is required. *RC H/SD*

per telecon 5-29-80

sh
 DISTRIBUTION OF THIS DOCUMENT IS UNLIMITED

CONTENTS

	Page
ABSTRACT	i
1. INTRODUCTION	1
2. METHOD OF ANALYSIS	2
3. RESULTS	3
4. REFERENCES	4
APPENDIX A - PNA DOWNSTREAM SHIELDING SUPPORT STRESS ANALYSIS	A-i
APPENDIX B - SAP IV SOURCE LISTING	B-i

1. INTRODUCTION

The purpose of this investigation was to determine the adequacy of the modified Pulsed Neutron Activation system structure to support the PNA sources, detectors, and lead shielding during the most severe design loading. The loading consisted of deadweight plus acceleration due to an 8-inch, hot-leg, 0.001 second opening time LOCE. Stresses in the modified downstream detector shielding support structure and the most highly stressed portions of the existing PNA structure were calculated and compared to AISC¹ and ASME² Code allowables. This stress analysis was performed for the PNA shielding configuration that has been used on Test L3-2 and that is to be used on Test L3-7.

2. METHOD OF ANALYSIS

Affected portions of the existing PNA structure along with the modified downstream shielding support structure³ were modelled using the SAP IV finite element computer program.⁴

Deadweight and three response spectrum runs (one for each of x, y, and z directions) were made. The response spectra were obtained from a computer analysis of the MTA.⁵ Ten percent damping was used in generating the response spectra to account for the damping effects of the lead brick shielding.

Beam element and plate element stresses from the SAP IV runs were calculated and combined, using the absolute sum of all force components, and compared to AISC and ASME Code allowables, respectively.

Some portions of the existing PNA structure were analyzed by multiplying the results of the previous PNA stress analysis⁶ by the ratio of the present shielding mass to the original shielding mass, while other parts were analyzed using the static-equivalent load method.⁷

The SAP IV computer output is not included in this report, but is available for inspection at the Applied Mechanics branch.

A listing of the SAP IV version used is included in Appendix B.

3. RESULTS

All components of the PNA shielding support structure analyzed in this investigation were found to be adequate.

Components not analyzed in this report include the actual methods of attachment of the lead shielding to the PNA source support structure, as mentioned in the previous PNA stress analysis.

4. REFERENCES

1. Manual of Steel Construction, American Institute of Steel Construction, 7th edition, 1970.
2. "Nuclear Power Plant Components," ASME Boiler and Pressure Vessel Code, American Society of Mechanical Engineers, Section III, Division 1, 1977.
3. EG&G Idaho, Inc., "LOFT Pulse Neutron Activation System," Drawing No. 210358, August 24, 1979.
4. R. C. Guenzler, IBM 360/75 and CDC7600 Versions of SAP IV, a Structural Analysis Program for Static and Dynamic Analysis of Linear Systems, TR-775, January 1976.
5. R. G. Rahl, "Stress Analysis of the LOFT Mobile Test Assembly," LTR 1110-20, February 20, 1974.
6. W. R. Mosby, "Stress Analysis of the Pulsed Neutron Activation System Support Structure," LTR LO-87-79-127, to be published.
7. RDT Standard F9-2T, Division of Reactor Research and Development, United States Atomic Energy Commission, January 1974.

LO 87 80 184

APPENDIX A

PNA DOWNSTREAM SHIELDING SUPPORT STRESS ANALYSIS

CALCULATION WORK SHEET

Subject PNA Downstream Shielding Support An. Page A-1 of _____ Pages
 Prepared By W.R. Mosby Checked _____ Work Request _____

Contents

I. Materials	2
A. Beams, channels, plate	2
B. Welds	3
C. Bolts	4
II. Arrangement of Structure	4
III. Loading Considered	4
IV. Existing structure affected by downstream shielding modifications	10
A. structural Members 1-10 (fig. 1)	10
B. Existing W6 x 25 beam, member 11 (fig. 1)	15
C. W6 x 15.5 beams, 12-14 (fig. 1)	17
V. New downstream shielding structure	19
A. W4 x 13 beams, members 15-24 (fig. 1, 2)	19
B. C6 x 13 channels, members 26 & 27 (fig. 1)	20
C. Plates used in downstream shielding box, member 25, fig. 1	21
VI. Connections	23
A. Connections in existing structure	23
B. Connections in new downstream shielding structure	24

CALCULATION WORK SHEET

Subject PNA Downstream Shielding Support An. Page A-2 of _____ Pages
 Date _____
 Prepared By W.R. Mosby Checked _____ Work Request _____

I. Materials

A. Beams, channels, plate

material - A-36 steel

$$S_y = 36,000 \text{ psi} = \text{yield stress}$$

$$S_u = 58,000 \text{ psi} = \text{ultimate stress}$$

$$\rho = .286 \text{ lb/in}^3$$

AISC code (Ref. 1) allowable stresses were used for all structural members except plates. For plates, the stress intensities for membrane stress alone and for membrane plus bending were compared to ASME (Ref. 2) allowable stress intensities of $\frac{2}{3} S_y$ and S_y , respectively.

For structural members other than plate, the following allowable stresses were used:

$$F_t = \text{allowable axial stress in tension} = .6 S_y$$

$$F_b = \text{allowable normal stress in bending} = .6 S_y$$

CALCULATION WORK SHEET

Subject PNA Downstream Shielding Support An. Page A-3 of _____ Pages
 Prepared By W. R. Mosby Checked _____ Work Request _____

$$F_v = \text{allowable shear stress} = .4 S_y$$

$$F_t = F_b = 21,600 \text{ psi}$$

$$F_v = 14,400 \text{ psi}$$

B. Welds

Weld metal : E7018 electrode

$$S_y = 60,000 \text{ psi}$$

$$S_u = 72,000 \text{ psi}$$

Allowable stress on effective area is the least of

$$.3(72,000) \text{ or } .4(36,000) = \underline{14,400 \text{ psi}}$$

where the weld stress is computed as

$$\sigma_w = \frac{\text{total (vector) force on weld}}{(\text{weld length})(\text{weld throat})}$$

C. Bolts ($\frac{1}{2}$ -13 UNC, A307 steel)

$F_t =$ allowable tensile stress based on area of .1419 in²

$$F_t = 20,000 \text{ psi}$$

CALCULATION WORK SHEET

Subject PNA Downstream Shielding Support An. Page A-4 of _____ Pages
 Prepared By W.R. Mosby Date _____
 Checked _____ Work Request _____

II. Arrangement of structure

Figures 1 and 2 show the physical arrangement of the structure considered in this analysis.

Figures 3, 4, and 5 show the SAP IV model of the structure used in this analysis.

III. Loading considered

The same loading used in the original PNA LOCE analysis (Ref. 6) was used in this analysis.

A plot of the spectra was shown in ref. 6 and will not be repeated here.

Static equivalent loads the same as in ref. 6 were used here:

$$A_x = \text{Acceleration in } x\text{-direction} = 1.5 (\text{spectrum peak}) = 4.46g$$

$$A_y = 2.81g$$

$$A_z = +1.46g, -3.46g$$

CALCULATION WORK SHEET

Subject Downstream Shielding Support An. Page A-5 of Pages
 Prepared By W. R. Mosby Date
 Checked Work Request

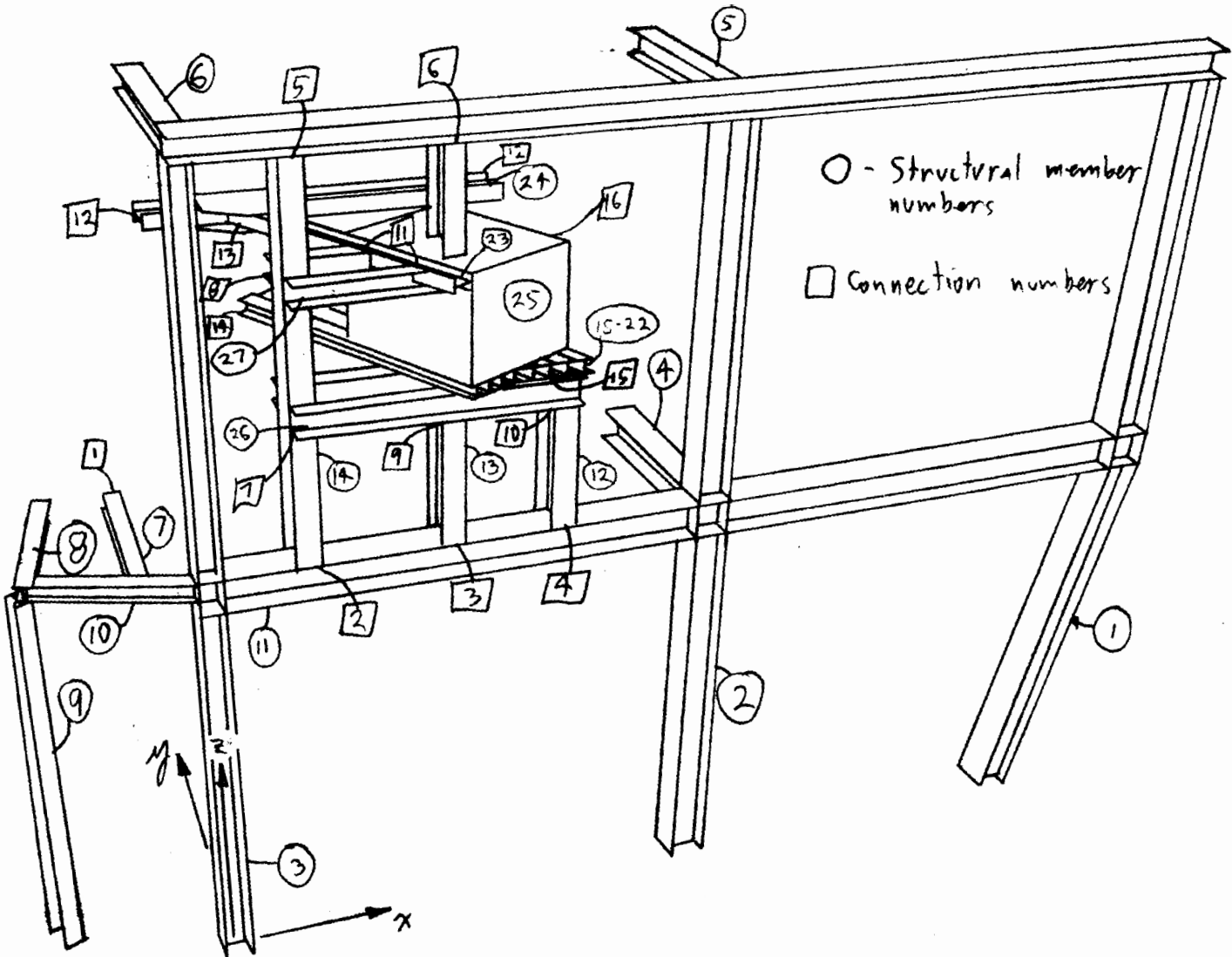

Figure 1: Overall view of shielding Support Structure looking toward MTA

CALCULATION WORK SHEET

Subject PNA Downstream Shielding Support Page A-6 of Pages
Prepared By W.R. Mosby Checked Work Request Date

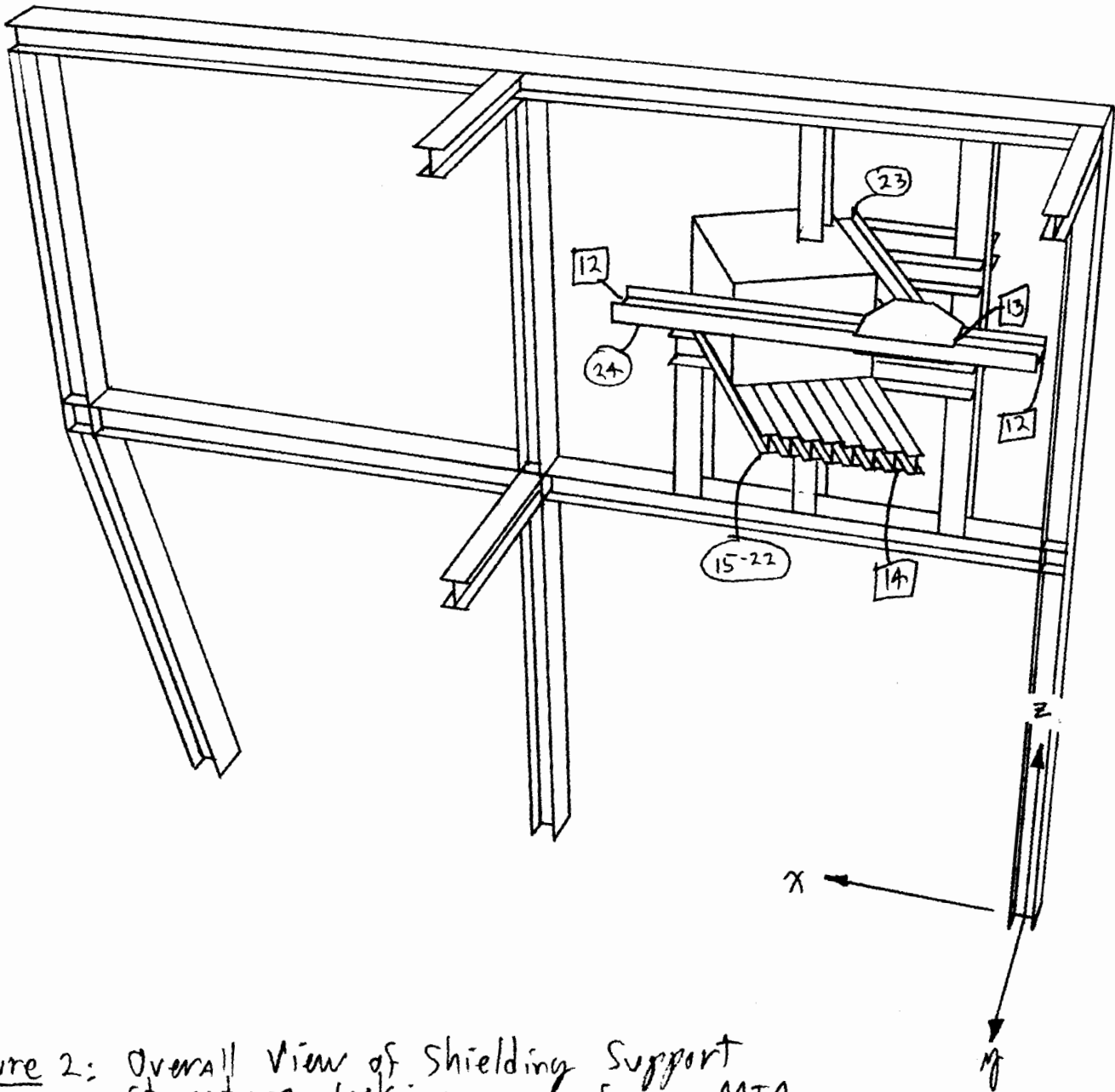

Figure 2: Overall View of Shielding Support Structure, looking away from MTA

CALCULATION WORK SHEET

Subject PNA Downstream Shielding Support An. Page A-7 of Pages
 Prepared By W.R. Mosby Checked Work Request Date

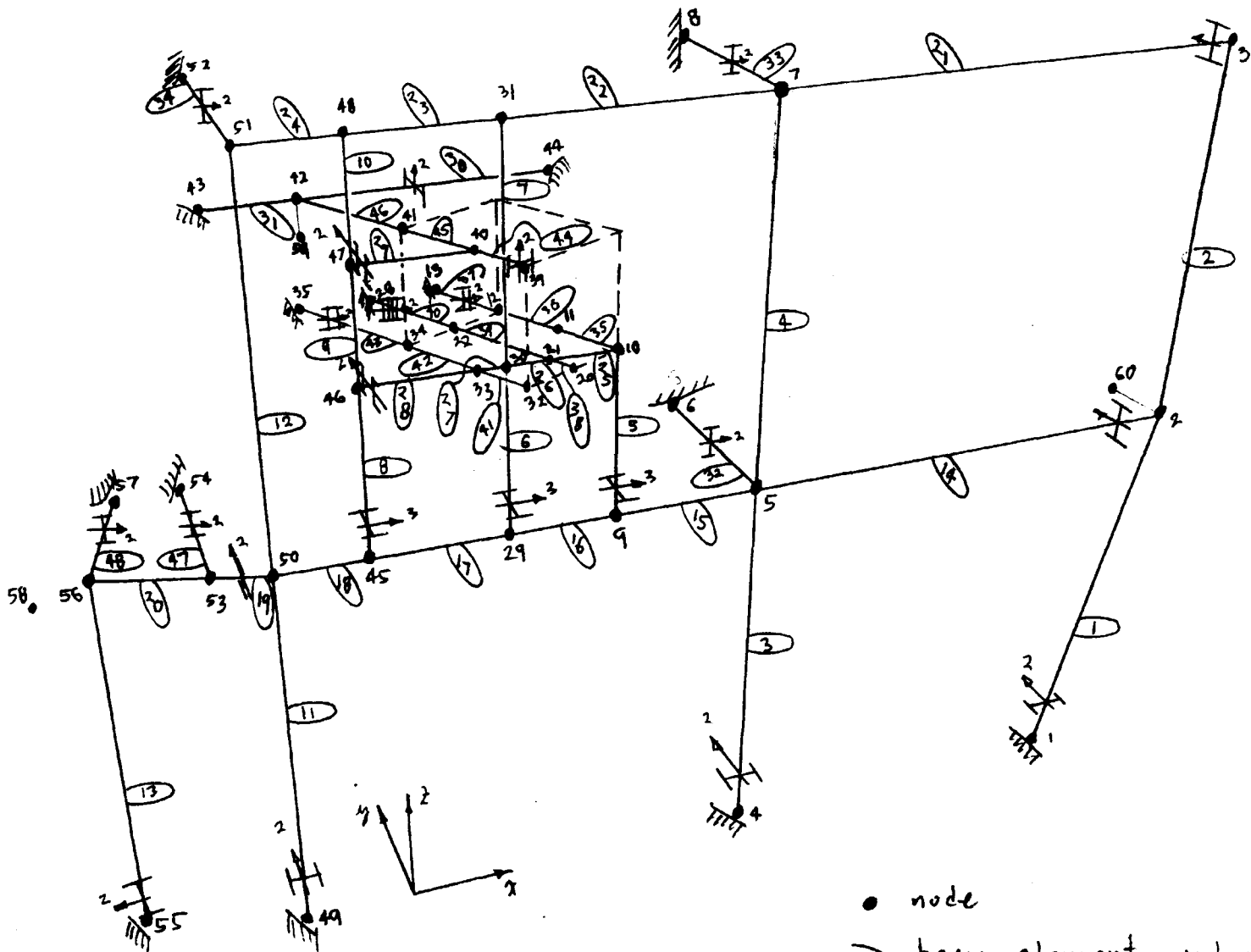

Figure 3 : SAP IV Model of Shielding Support structure

- node
- beam element number
- I section schematic and orientation
- ▨ built-in beam end



CALCULATION WORK SHEET

Subject PNA Downstream Shielding Support An. Page A-8 of Pages
Prepared By W.R. Mesby Checked Date
Work Request

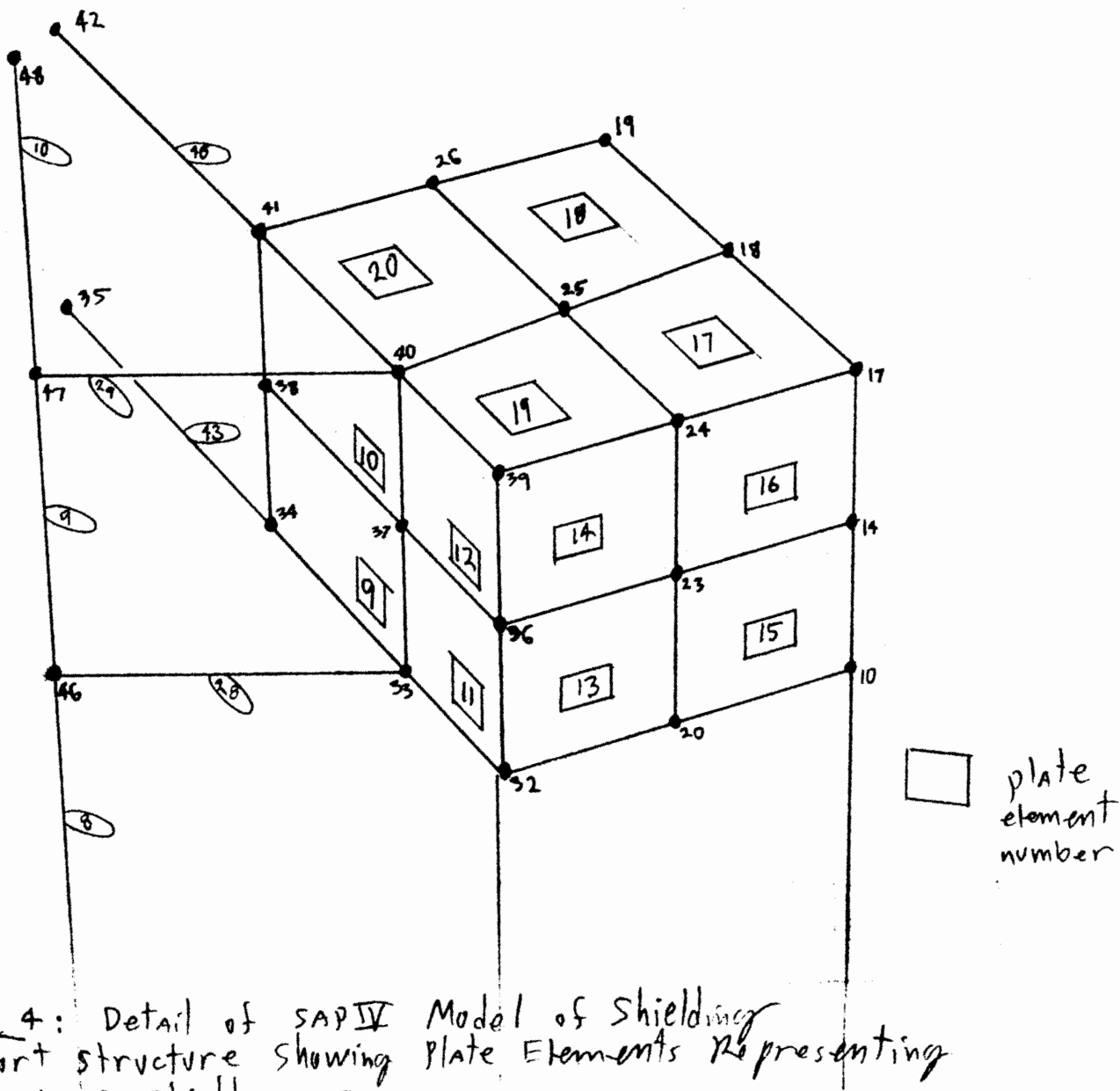

Figure 4: Detail of SAP IV Model of Shielding support structure showing Plate Elements representing Front of Shielding Box



EG&G

Idaho, Inc.

FORM EG&G-1882
(Rev. 6-77)

LO 87 80 134

CALCULATION WORK SHEET

Page A-9 of _____ Pages

Subject PNA Downstream Shielding Support An. Date _____

Prepared By W.R. Mosby Checked _____ Work Request _____

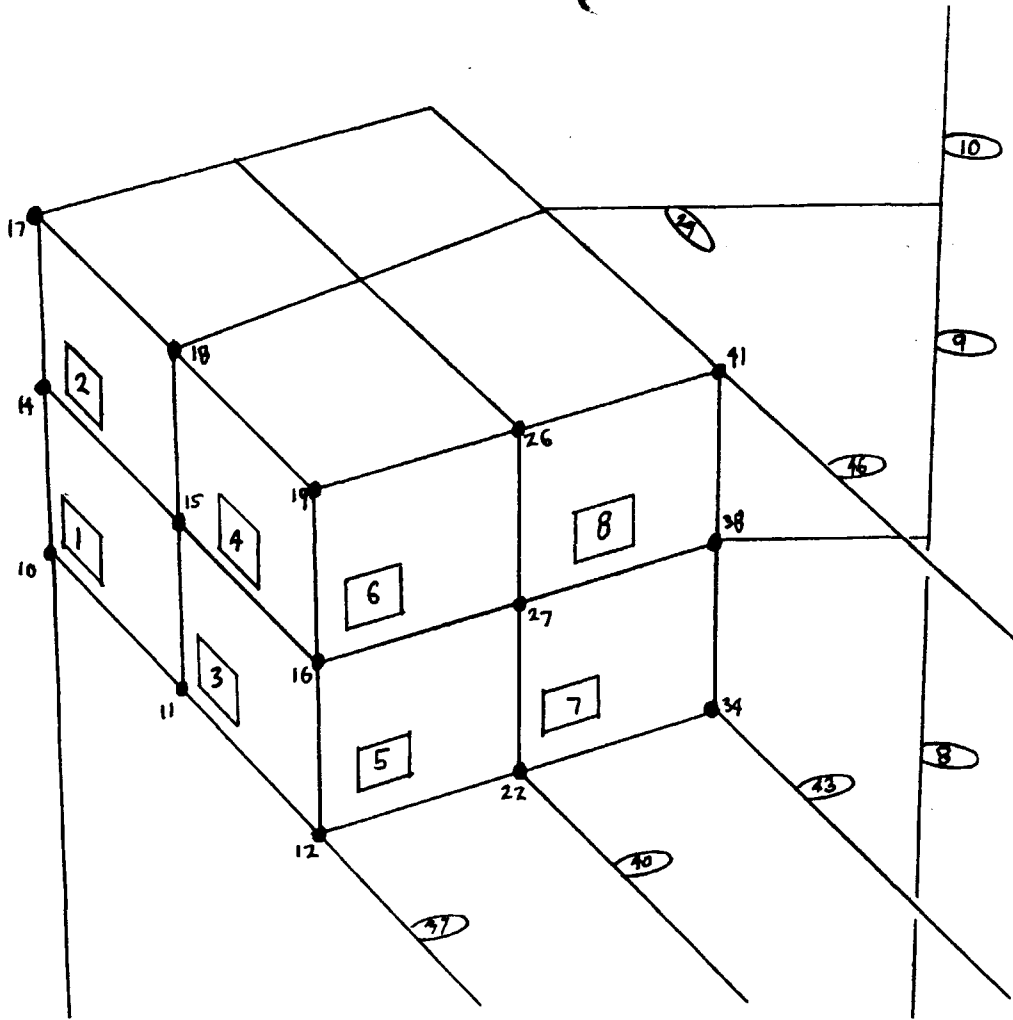

Figure 5: Detail of SAPIV Model of Shielding Support Structure showing Plate Elements Representing Rear of Shielding Box

CALCULATION WORK SHEET

Subject PNA Downstream Shielding Support An. Page A-10 of _____ Pages
Prepared By W.R. Mosby Date _____
Checked _____ Work Request _____

IV. Existing structure affected by downstream shielding modifications

A. Structural members 1-10 (fig. 1)

These members were analyzed previously (Ref. 6).

The results of this analysis are in the form of

$$R = \frac{\text{combined stress}}{\text{allowable stress}} \quad ?$$

From Ref. 1, part 5, section 1.6, equations 1.6-1a, 1.6-1b, and 1.6-2 as applicable. These members will be more severely stressed in the present case due to An (next page)

CALCULATION WORK SHEET

Subject PNA Downstream Shielding Support An. Page A-11 of _____ Pages
 Prepared By W.R. Mosby Date _____
 Checked _____ Work Request _____

increased shielding weight. Therefore new values of R can be conservatively calculated by multiplying R by

$$\frac{\text{weight of new downstream} + \text{source shielding}}{\text{weight of source shielding}}$$

This is conservative because it neglects the weight of the old downstream shielding which would appear in the denominator.

Weight of new downstream shielding

$$= .42 \frac{\text{lb}}{\text{in}^3} \times 28 \text{ in} \times 24 \text{ in} \times 34.75 \text{ in} = 9807 \text{ lb}$$

weight of source shielding (ref. E) = 7903

$$R' = R \left(\frac{9807 + 7903}{7903} \right) = \underline{\underline{2.24 R}}$$

Table I shows the results of this procedure.

CALCULATION WORK SHEET

Page A-15 of _____ Pages
 Subject PNA Downstream Shielding Support An. Date _____
 Prepared By W.R. Mosby Checked _____ Work Request _____

B. Existing W6x25 beam, member 11 (Fig. 1)

Almost all the loading on this beam is due to deadweight and LOCE z-accelerations. (fig 6).

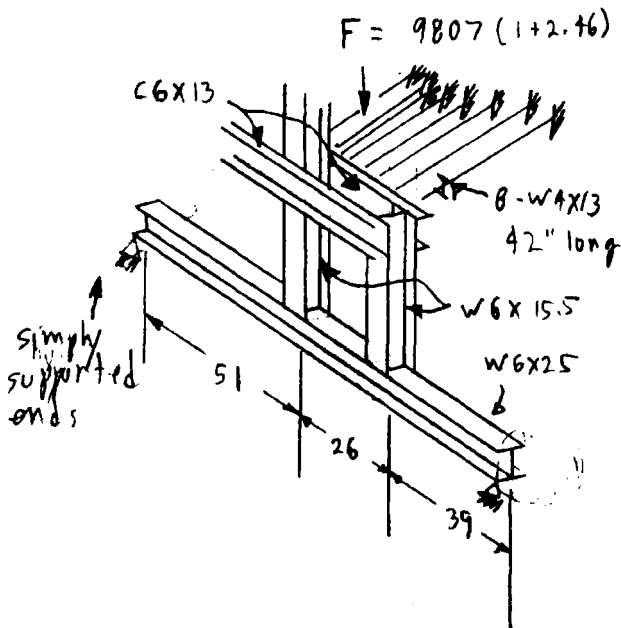

Figure 6: Existing W6x25 beam: arrangement

The total force acts on both the W6x25 beam and on 8-W4x13 beams of average length 42 inches.

The stiffness of the 8 W4x13's together is

$$K_1 = \frac{2EI}{l^3} = \frac{2(29 \times 10^6)(11.3)}{42^3}$$

$$K_1 = \underline{\underline{7.077 \times 10^9 \text{ lb/in}}}$$

The stiffness of the W6x25 beam will be calculated by assuming that half the load is applied by each vertical W6x15.5 and using the average

CALCULATION WORK SHEET

Subject PNA Downstream Shielding Support An. Date _____ Page A-16 of _____ Pages
 Prepared By W.R. Mosby Checked _____ Work Request _____

of the deflections calculated at both points (Fig. 7)

From Ref. 1,

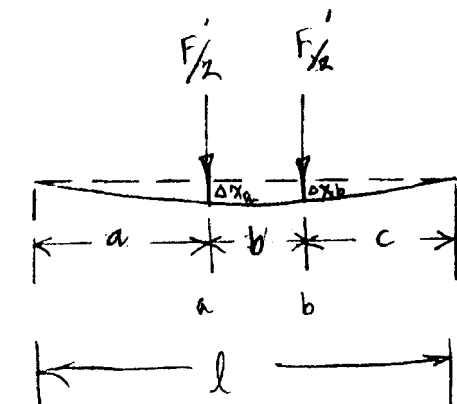

$$\Delta x_a = \text{deflection at } a$$

$$= \frac{F a}{12 E I l} \left[(l^2 - a^2)(b + 2c) - (b + c)^3 + c^3 \right]$$

$$\Delta x_b = \frac{F c}{12 E I l} \left[(l^2 - c^2)(b + 2a) - (a + b)^3 + a^3 \right]$$

Figure 7: W6x25 beam (#11, Fig. 1)

With $l = 116$
 $a = 51$
 $b = 26$

$c = 39$
 $E = 29 \times 10^6$
 $I = 53.3$

$$\Delta x = \frac{1}{2} (\Delta x_a + \Delta x_b) = 1.793 \times 10^{-5} F'$$

$$K = K_2 = \frac{F'}{\Delta x} = \underline{\underline{5.578 \times 10^9 \text{ lb/in}}}$$

The total force applied to the W6x25 beam is

$$F' = \frac{5.578 \times 10^9}{7.077 \times 10^9 + 5.578 \times 10^9} (9807)(3.76) = \underline{\underline{14,956 \text{ lb}}}$$

CALCULATION WORK SHEET

Subject PNA Downstream Shielding Support An. Page A-17 of _____ Pages
 Date _____
 Prepared By W.R. Mosby Checked _____ Work Request _____

Bending moment at a & b:

$$M_a = \frac{1}{2} F' \left\{ \frac{(b+c)(a)}{l} + \frac{(c)(a)}{l} \right\} = 22.86 F'$$

$$M_b = \frac{1}{2} F' \left\{ \frac{cb + 2ca}{l} \right\} = 21.52 F'$$

MAX moment = $M_a = 341,894$ in-lb

$S = 16.7$ for W6X25, so

$$f_b = \frac{341,894}{16.7} = 20,473 \text{ psi} < 0.6 \text{ yield} = 21,600 \text{ psi}$$

C. W6X15.5 beams, members 12-14, Fig. 1

Loads (maximum)

$$R_1 = 8108 \text{ lb}$$

$$T_1 = 95 \text{ in-lb}$$

$$V_2 = 2606 \text{ lb}$$

$$M_2 = 17,410 \text{ in-lb}$$

$$V_3 = 461 \text{ lb}$$

$$M_3 = 58,504 \text{ in-lb}$$

$$f_a = \frac{8,108}{4.57} = 1,774 \text{ psi}$$

$$f_{b_2} = \frac{17,410}{10} = 1,741 \text{ psi}$$

$$f_v \leq \frac{2,606}{3.23} + \frac{461}{1.41} + \frac{95(1.235)}{.111} \quad f_{b_3} = \frac{58,504}{3.23} = 18,113 \text{ psi}$$

$$= 1335 \text{ psi}$$

CALCULATION WORK SHEET

Subject PNA Downstream Shielding Support An. Page A-18 of _____ Pages
 Date _____
 Prepared By W.R. Mosby Checked _____ Work Request _____

shear

$$\frac{f_r}{F_r} = \frac{1,335}{14,400} = .09 < 1$$

combined

$$\frac{Kl}{r} \leq \frac{(1)(92)}{1.46} = 63 < C_c$$

$$C_c = 126.1, \quad \frac{Kl/r}{C_c} = .5$$

$$F_a = \frac{[1 - \frac{1}{2}(.5)^2] 36,000}{\frac{5}{8} + \frac{3}{8}(.5) - \frac{1}{8}(.5)^2} = 17,133 \text{ psi}$$

$$F_e' \leq \frac{12(\pi^2)(29 \times 10^3)}{23(63)^2} = 37,624$$

$$C_m = .85, \quad F_b = .6(36,000) = 21,600; \quad \text{eqns. 1.6-1a + -1b}$$

are then:

$$1.6-1a \quad \frac{1774}{17133} + \frac{.85(1741)}{(1 - \frac{1774}{37624})21,600} + \frac{.85(18,133)}{(1 - \frac{1774}{37,624})21,600} = \underline{\underline{.92 < 1}}$$

$$1.6-1b \quad \frac{1774}{21,600} + \frac{1741 + 18133}{21,600} = \underline{\underline{1.00}}, \text{ so ok.}$$

CALCULATION WORK SHEET

Subject PNA Downstream Shielding Support Anc. Date _____ Page A-19 of _____ Pages
 Prepared By W.R. Mosby Checked _____ Work Request _____

V. New downstream shield structure
 A. W4 x13 beams, members 15-24

Loads (MAXimum) -

$$R_1 = 3271 \text{ lbs}$$

$$T_1 = 935 \text{ lbs}$$

$$V_2 = 1243 \text{ lbs}$$

$$M_2 = 45190 \text{ in-lbs}$$

$$V_3 = 3235 \text{ lbs}$$

$$M_3 = 19,776 \text{ in-lbs}$$

stresses -

$$f_a = \frac{3271}{3.82} = 856 \text{ psi}$$

$$f_{b_2} = \frac{45,190}{5.45} = 8292 \text{ psi}$$

$$f_w \leq \frac{1243}{2.8} + \frac{3235}{1.17} + \frac{935(.20)}{.154}$$

$$f_{b_3} = \frac{19,776}{1.85} = 10,690 \text{ psi}$$

$$= 4909 \text{ psi}$$

Allowable stresses (ref. 1)

$$C_c = 106.1, \quad \frac{K \cdot l}{r} \approx \frac{1(.80)}{.991} = 80.73, \quad \frac{K \cdot l / r}{C_c} = .64$$

$$F_a = \frac{[1 - \frac{1}{2}(.64)^4](36,000)}{\frac{5}{3} + \frac{3}{8}(.64) - \frac{1}{8}(.64)^3} = 15,277 \text{ psi}$$

$$\frac{f_a}{F_a} = \frac{856}{15,277} = .06, \quad \text{so eqn. 1.6-2 applies}$$

CALCULATION WORK SHEET

Subject PNA Downstream Shielding Support An. Page A-20 of _____ Pages
 Date _____
 Prepared By W.R. Mosby Checked _____ Work Request _____

$$.06 + \frac{8292 + 10,690}{21,600} = \underline{\underline{.94 < 1}}$$

$$\frac{f_v}{F_v} = \frac{4909}{14,400} = \underline{\underline{.34 < 1}}$$

B. C 6 x 13 channels, members 26+27, fig. 1

Loads (max)

$R_1 = 6828$

$T_1 = 882$

$V_2 = 1229$

$M_2 = 57,618$

$V_3 = 4083$

$M_3 = 11,310$

section properties

$A_1 = 7.66 \text{ in}^2$

$J_1 = .482, k_1 = .343$

$r = .525$

$A_2 = 2.959 \text{ in}^2$

$S_2 = 11.6$

$A_3 = 5.299 \text{ in}^2$

$S_3 = 1.28$

Stresses

$f_a = \frac{6828}{7.66} = 891 \text{ psi}$

$f_{b_2} = \frac{57,618}{11.6} = 4967 \text{ psi}$

$f_v = \frac{1229}{2.959} + \frac{4083}{5.299} + \frac{882(.343)}{.482} = 1822 \text{ psi}; f_{b_3} = \frac{11,310}{1.28} = 8836 \text{ psi}$

CALCULATION WORK SHEET

Subject PNA Downstream Shielding Support An. Page A-22 of _____ Pages
 Date _____
 Prepared By W.R. Mosby Checked _____ Work Request _____

bending stresses + membrane stresses

$$\left. \begin{aligned}
 \sigma_x &= 6496 + 742 = 7238 \\
 \sigma_y &= 8270 + 1079 = 9349 \\
 \tau_{xy} &= 12237 + 2296 = 14533
 \end{aligned} \right\} 2\tau_{\max \text{ memb} + \text{ bend}} = 29,371 \text{ psi}$$

Allowable stresses - the ASME code (Ref. 1)
 will be used as a guide here, since the
 AISC code (Ref. 1) does not address plate
 structures -

$$\begin{aligned}
 \text{allowable membrane stress intensity} &= \frac{2}{3}(36,000) = \underline{24,000 \text{ psi}} \\
 \text{allowable memb. + bending stress intens.} &= \underline{36,000}
 \end{aligned}$$

$$\text{so } \frac{2\tau_{\max \text{ memb}}}{24,000} = \underline{\underline{.21 < 1}}$$

$$\frac{2\tau_{\max \text{ memb} + \text{ bend}}}{36,000} = \underline{\underline{.82 < 1}}$$

CALCULATION WORK SHEET

Page A-23 of _____ Pages
 Subject PNA Downstream Shielding Support An. Date _____
 Prepared By W.R. Mosby Checked _____ Work Request _____

VI. Connections

A. Connections in existing structure

The method of **IV. A.** (p. 10) will be used

1. Connection of angled W4X13 beam to MTA built-up beam (fig. 1), connection # 1)

See ref. 6, p. 69: this is the most highly stressed major connection in the source structure, so re-analyze:

$R_1 = 2988$ $T_1 = 123$ (See fig. 3, node 54)

$V_2 = 1953(2.24) = 4375; M_2 = 8031$

$V_3 = 1162$ $M_3 = 16,960(2.24) = 37,990$

at ①

$$\left. \begin{aligned} \tau_{12} &= \frac{2988}{2.683} + \frac{2(37,990)}{2.683(4.06)} = 8,089 \text{ psi} \\ \sigma_2 &= \frac{4375}{2.683} = 1631 \text{ psi} \\ \tau_{32} &= 3699 \text{ psi} \end{aligned} \right\} \sigma_{\max} = \underline{\underline{8946 \text{ psi} < 14,400}}$$

at ②

$$\left. \begin{aligned} \tau_{13} &= 8089 \\ \tau_{23} &= 1631 \\ \sigma_3 &= 3699 \end{aligned} \right\} \sigma_{\max} = \underline{\underline{10,111 \text{ psi} < 14,400 \text{ psi}}}$$

CALCULATION WORK SHEET

Subject PNA Downstream Shielding Support An. Page A-25 of _____ Pages
 Prepared By W.R. Mosby Checked _____ Date _____
 Work Request _____

LOADS

$$R_1 = 6828 \text{ lb}$$

$$T_1 = 882 \text{ in-lb}$$

$$V_2 = 1229 \text{ lb}$$

$$M_2 = 57,618 \text{ in-lb}$$

$$V_3 = 4083 \text{ lb}$$

$$M_3 = 11,310 \text{ in-lb}$$

Forces parallel to weld

due to R_1 : $F'_{R_1} = \frac{6828}{4(6)} = \underline{285 \text{ lb/in}}$

due to M_2 :

$$\frac{1}{4}(57,618) = F'_{m_2}(3)(6) \Rightarrow F'_{m_2} = \underline{800 \text{ lb/in}}$$

Forces perpendicular to weld

due to V_2

$$F'_{V_2} = \frac{1229}{4(6)} = \underline{51 \text{ lb/in}}$$

due to V_3

$$F'_{V_3} = \frac{4083}{4(6)} = \underline{170 \text{ lb/in}}$$

due to T_1 : $F'_{T_1} = \frac{882}{6(2)(6)} = \underline{12 \text{ lb/in}}$

CALCULATION WORK SHEET

Subject PVA Downstream Shielding Support An. Page A-26 of Pages
 Prepared By W.R. Mosby Checked Work Request

due to M_3

$$2 \left\{ 2 \left(\frac{1}{2} F'_{m_3} \right) (3) \right\} = \frac{1}{4} (11,310)$$

$$F'_{m_3} = 471.25 \text{ lb/in}$$

$$\begin{aligned} \text{total force/in} &= \sqrt{(285 + 800)^2 + (51 + 12 + 471.25)^2 + 170^2} \\ &= 1221 \text{ lb/in} \end{aligned}$$

$$\sigma_{\text{weld}} = \frac{1221}{(1.707)(.25)} = \underline{\underline{6910 \text{ psi} < 14,400 \text{ psi}}}$$

2. Connections between C 6 X 13 channels and W 4 X 13 beam (fig. 1, # 11)

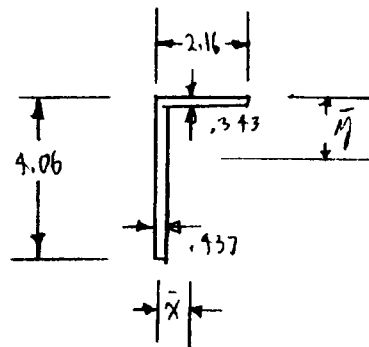
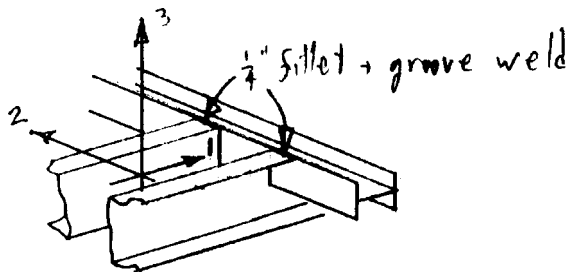

Figure 9: Connections between C 6 X 13 channels and W 4 X 13 beam

CALCULATION WORK SHEET

Subject PNA Downstream Shielding Support An. Page A-27 of _____ Pages
 Prepared By W.R. Mosby Date _____
 Checked _____ Work Request _____

Weld section properties -

$$Area = 2 (.343 (2.16 - .437) + .437 (4.06)) = 4.73 \text{ in}^2$$

$$\bar{x} = \frac{.437 (1.624) + \frac{2.16}{2} (.191)}{1.624 + .741} = .488 \text{ in}$$

$$I_{xx} = \underline{.692 \text{ in}^4}$$

$$\bar{y} = \frac{\frac{4.06}{2} (1.774) + \frac{.343}{2} (.591)}{.591 + 1.774} = 1.566 \text{ in}$$

$$I_{yy} = \underline{3.979 \text{ in}^4}$$

Loads

$$R_1 = 1952 \text{ lb}$$

$$T_1 = 298 \text{ in-lb}$$

$$V_2 = 308 \text{ lb}$$

$$M_2 = 7497 \text{ in-lb}$$

$$V_3 = 1322 \text{ lb}$$

$$M_3 = 7771 \text{ in-lb}$$

forces

parallel to weld

$$\text{due to } V_2 : \frac{308}{4.32} = 71.3 \text{ lb/in.}$$

CALCULATION WORK SHEET

Subject PNA Downstream Shielding Support An. Page A-28 of _____ Pages
 Date _____
 Prepared By W.R. Mosby Checked _____ Work Request _____

$$\text{due to } V_3 : \frac{1322}{8.12} = 163 \text{ lb/in}$$

$$\text{due to } T_1 : \frac{298}{6(4.06)} = 12.2 \text{ lb/in}$$

normal to wall

due to M_2

$$\frac{7497(4.06 - 1.566)}{2(3.974)} (.437) = 1028 \text{ lb/in}$$

due to M_3

$$\frac{7771(2.16 - .988)}{2(.692)} (.343) = 3220 \text{ lb/in}$$

due to R_1

$$\frac{1952}{2(4.06 + 2.16)} = 157 \text{ lb/in}$$

$$\begin{aligned} \text{max force/in} &\leq \sqrt{(3220 + 157)^2 + (163 + 12.2)^2} \\ &= 3382 \text{ lb/in} \end{aligned}$$

CALCULATION WORK SHEET

Subject PNA Downstream Shielding Support An Page A-29 of Pages
 Prepared By W.R. Mosby Checked Work Request

so weld stress = $\frac{3382}{.343} = 9959 \text{ psi} < 19,400$

3. Connection between W4X13 beam and MTA built-up beams (fig. 1, #12; fig. 10)

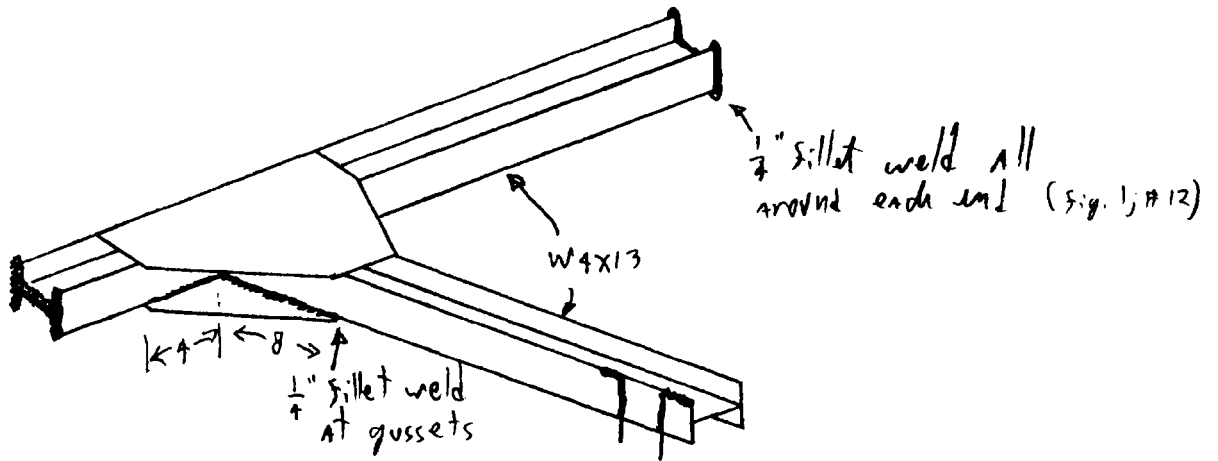
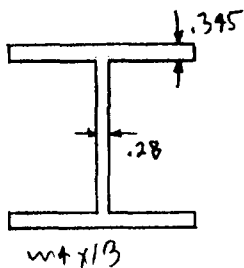

Figure 10: W4X13 beam structure

strength of connection -



Effective weld leg - thicknesses of section are greater than 1/4 inch, so Res. 1, sec. 1.17.6 applies -

CALCULATION WORK SHEET

Subject PNA Downstream Shielding Support An. Page A-30 of Pages
 Prepared By W.R. Mosby Checked Work Request

and maximum weld size is $\frac{1}{16}$ inch less than material thickness

flanges : $.345 - \frac{1}{16} = .2825 \Rightarrow .25$ inch leg, a

web : $.28 - \frac{1}{16} = .2175$ inch leg, a

$a < \frac{3}{8}$ in each case, so the weld throat is equal to the weld leg, .25 and .22 inches, respectively. The weld allowable stress is

19,400 psi vs. 21,600 psi for the base metal.

To allow for this, reduce the effective weld throats by $\frac{19,400}{21,600} = .67$ to .17 in and .15 in, respectively. The weld pattern is then:

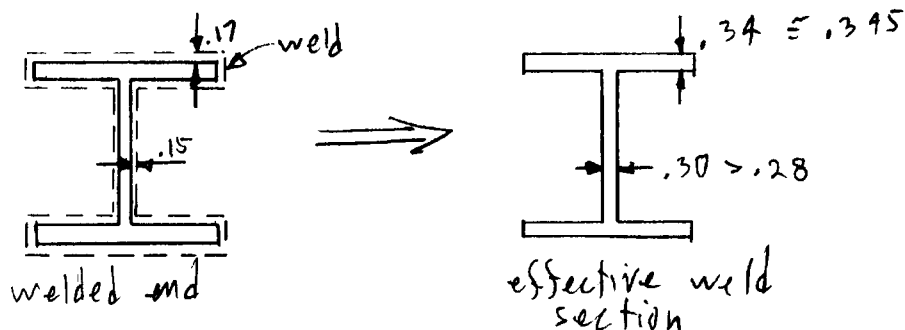

CALCULATION WORK SHEET

Subject PNA Downstream Shielding Support An. Page A-31 of Pages
 Prepared By W.R. Mosby Checked Date
 Work Request

The effective weld section is as strong as the beam itself, so no further analysis is required.

By inspection, the gusset welds (Fig. 1, # 43; Fig. 10) are stronger than the end welds just considered.

4. Connections between 8 W4X13 beams and MTA built-up beam and C6X13 channels (Fig. 1, # 14915)

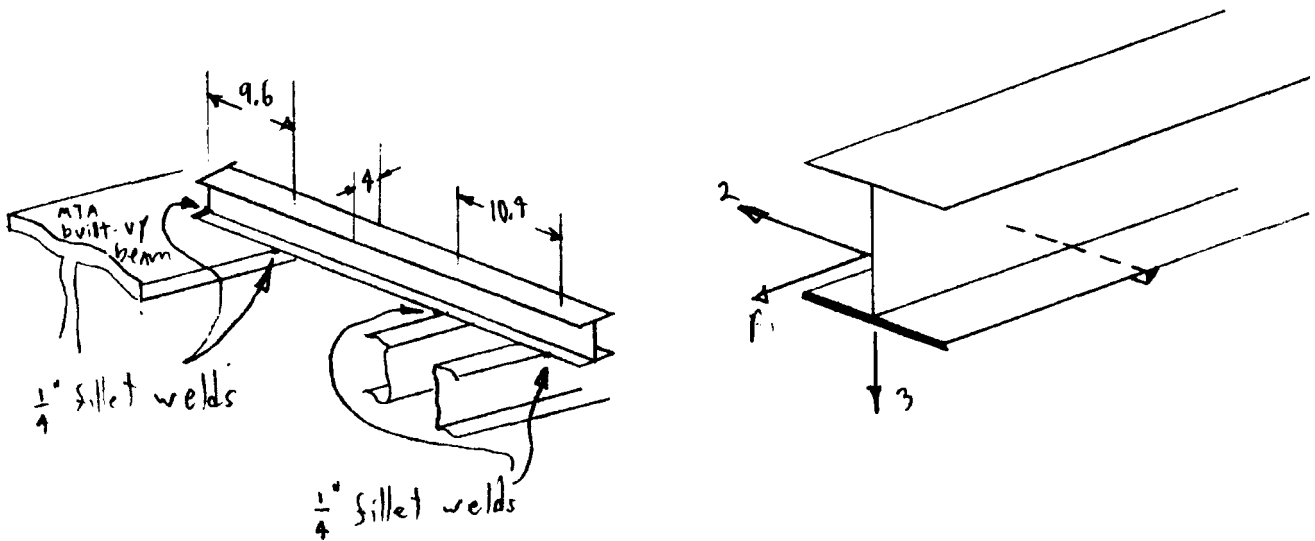

The weld at the built-up beam end is the weaker, so analyze it with the worst loads.

CALCULATION WORK SHEET

Subject PNA Downstream Shielding Support An. Page A-32 of _____ Pages
 Date _____
 Prepared By W. R. Mosby Checked _____ Work Request _____

LOADS

$$R_1 = 1297 \text{ lb}$$

$$T_1 = 25 \text{ in-lb} \cong 0$$

$$V_2 = 306 \text{ lb}$$

$$M_2 = 51465 \text{ in-lb}$$

$$V_3 = 777 \text{ lb}$$

$$M_3 = 13,312 \text{ in-lb}$$

Forces parallel to weld

due to V_2

$$F'_{V_2} = \frac{306}{8} = 38.25 \text{ lb/in}$$

due to M_3

$$F'_{M_3} = \frac{13,312}{9.6(4)} = 347 \text{ lb/in}$$

Forces perpendicular to weld

-1 direction

due to R_1

$$F'_{R_1} = \frac{1297}{8} = 162 \text{ lb/in}$$

CALCULATION WORK SHEET

Subject PNA Downstream Shielding Support for Page A-33 of _____ Pages
 Prepared By W.R. Alley Checked _____ Date _____
 Work Request _____

in -3 direction

due to M_2

$$F'_{M_2} = \frac{51965}{9.6(4)} = 1340 \text{ lb/in}$$

$$\begin{aligned} \text{Total weld force/in} &= \sqrt{(347 + 38.25)^2 + 162^2 + 1390^2} \\ &= 1404 \text{ lb/in} \end{aligned}$$

$$\text{weld stress} = \frac{1404}{(707)(.25)} = \underline{\underline{7992 \text{ psi} < 19,900 \text{ psi}}}$$

S. Connections between plates in welded box structure

The plates are nearly simply-supported, so the welds are only subject to the membrane stresses in the plates

Loads max normal stress in plate = 3191 psi
 max shear stress in plate = 2296 psi

CALCULATION WORK SHEET

Page A-34 of _____ Pages
 Subject PNA Downstream Shielding Support An. Date _____
 Prepared By W.R. Mosby Checked _____ Work Request _____

weld forces/inch

$$\text{parallel} = 2296 (.25) = 574 \text{ lb/in}$$

$$\text{normal} = 3141 (.25) = 785 \text{ lb/in}$$

$$\text{total} = 973 \text{ lb/in}$$

$$\text{weld stress} = \frac{973}{.707(.25)} = \underline{\underline{5505 \text{ psi} < 19,900 \text{ psi}}}$$

6. Bolted connection in shield box structure (fig. 1, #17)

18 bolts, $\frac{1}{2}$ inch - 13 VNC

$$\text{stress} = \frac{9807 \text{ lb} (4.46)}{18 (.1414)} = \underline{\underline{17,127 \text{ psi} < 20,000 \text{ psi}}}$$

the bolts attach the cover plate to the box through a welded angle 20 inches long (See sketch),

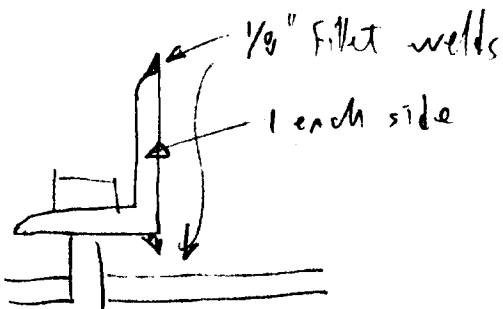

$$\text{weld stress} = \frac{9807 (4.46)}{80 (.125) (.707)} = \underline{\underline{6187 \text{ psi} < 19,900 \text{ psi}}}$$

APPENDIX B
SAP IV SOURCE LISTING

CALCULATION WORK SHEET

Subject SAP IV Source Listing Page B-1 of _____ Pages
Date _____
Prepared By _____ Checked _____ Work Request _____

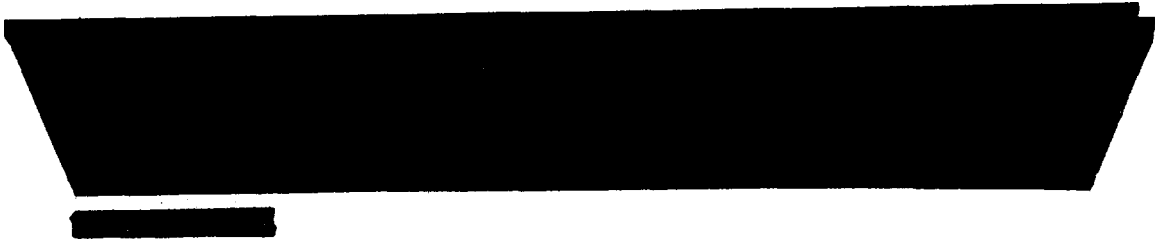

SAP IV Source Listing