

ICLRM

International Center for Laboratory Risk Management

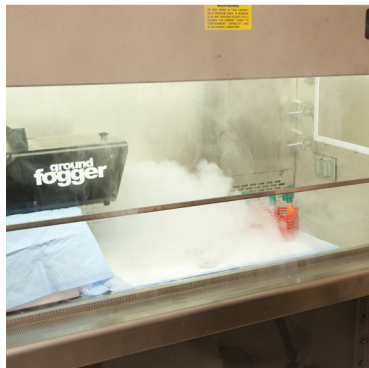
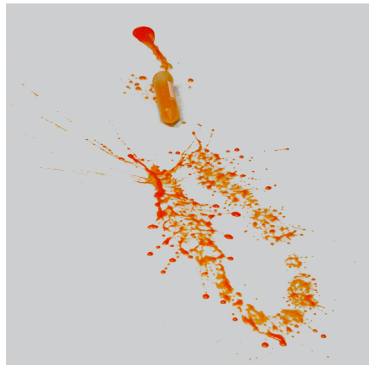

Sandia and International Cooperative Threat Reduction

Sandia National Laboratories' International Cooperative Threat Reduction (CTR) group enhances US national security by developing and implementing innovative solutions for countering nuclear, biological, and chemical threats across the globe. The group carries out training and cooperative research activities that enable Sandia and its partners to reduce the global threat posed by Weapons of Mass Destruction (WMD). Increasing commitments to this effort have lead the International Cooperative Threat Reduction team to consider establishing a large laboratory training facility in Albuquerque, New Mexico.

An existing training lab, located in the Training and Technology Demonstration Area in Sandia's International Programs Building, lacks the capability to adapt to evolving training requirements. An expanded facility would greatly enhance the CTR team's ability to deliver technical training using a broad range of approaches.

Increasing Capabilities to Reduce Threats

The proposed training center, the International Center for Laboratory Risk Management (ICLRM), will provide an authentic laboratory setting in which to develop international technical cooperation and conduct legitimate research activities.

The ICLRM will be intrinsically versatile. Instructors will be able to deliver training via multiple formats - both on-site and via distance learning - for domestic and international audiences. As lab infrastructure and conditions vary dramatically between developed and developing countries, the ICLRM's configurability will enable the creation of a learning environment that reflects reality; students will train in a setting they identify with.

Scope of Activity

ICLRM courses, encompassing a range of topics, will be provided both onsite and through a robust distance learning capability:

- Laboratory security best practices for working with biological and chemical materials
- Demonstration of Integrated Security Systems - proper installation, maintenance, use and inspection of safety and security equipment commonly utilized in laboratory environments
- Risk Management Planning
- Response Protocols

Additionally, the ICLRM will serve as a site for conducting field exercises and simulations of laboratory safety and security-related events, further enabling the CTR team to conduct training under the most realistic conditions possible.

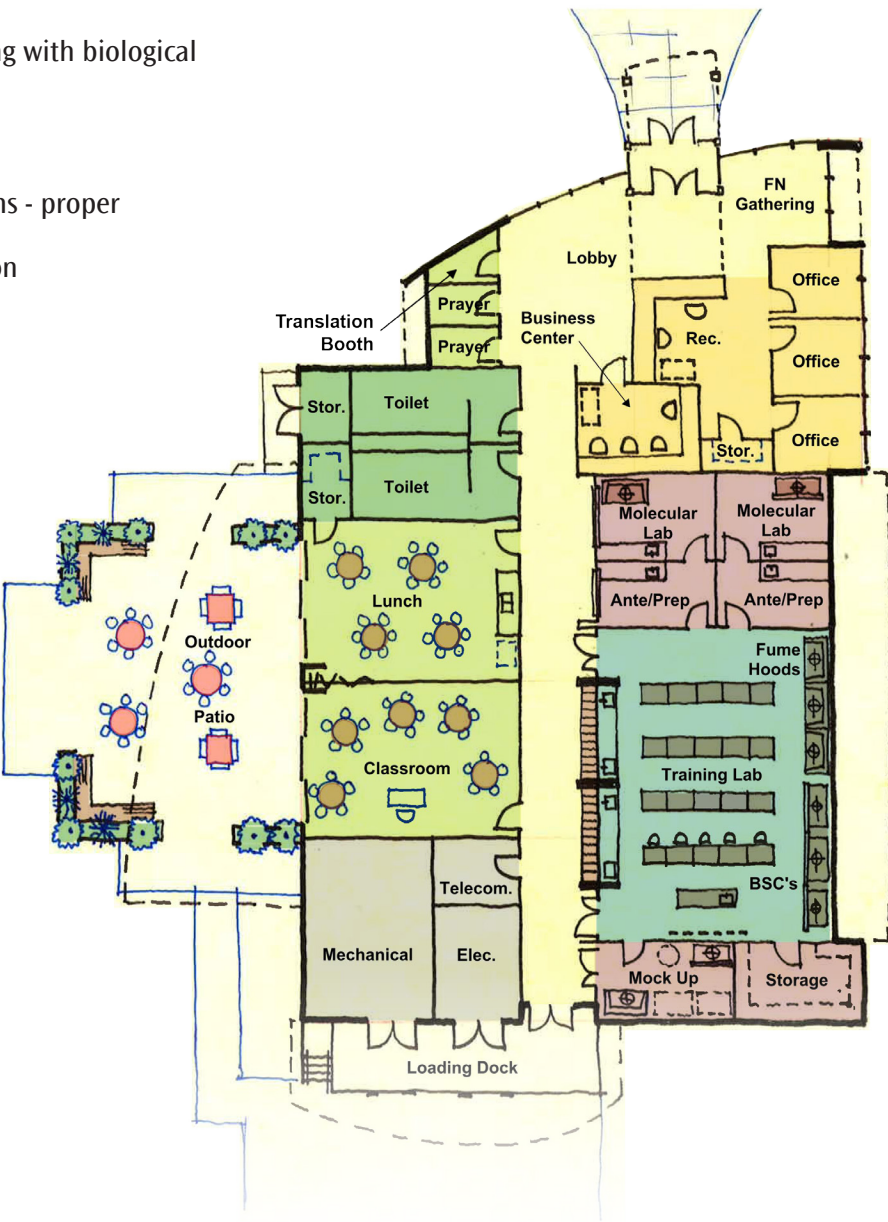

FOR MORE
INFORMATION,
PLEASE CONTACT:

BENJAMIN H. BRODSKY
bhbrods@sandia.gov | 505.284.4502

LYNN FONDREN
lfondre@sandia.gov | 505.284.1746